

Item NO.	Product Name	Product NO.	QTY	Page	Description
①	EW-D50固定卡环	97.76.748.06	1	4	t=1.0mm 1060AL, Andoizing.
②	1-1222-H		1	2	t=1.2mm 1090AL, Andoizing.
③	EW-50透明片	97.70.364.00	1	3	PC

table for unmentioned tolerance in the drawing (unit: mm)				punch angle tolerance in the drawing (unit: degree)		
> 0-5	> 5-30	> 30-90	> 90-150	0-10	10-50	50-120
±0.15	±0.2	±0.4	±0.5	±1°	±0.5°	±0.3°
> 150-250	> 250-400	> 400-700		120-250	250-360	360 above
±0.8	±1.5	±2		±0.2°	±0.166°	±0.085°

“*” Marked for key control dimensions

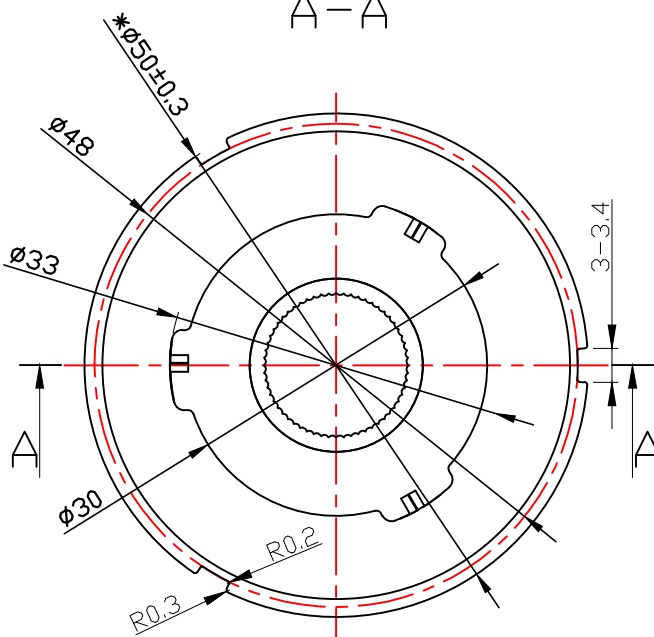
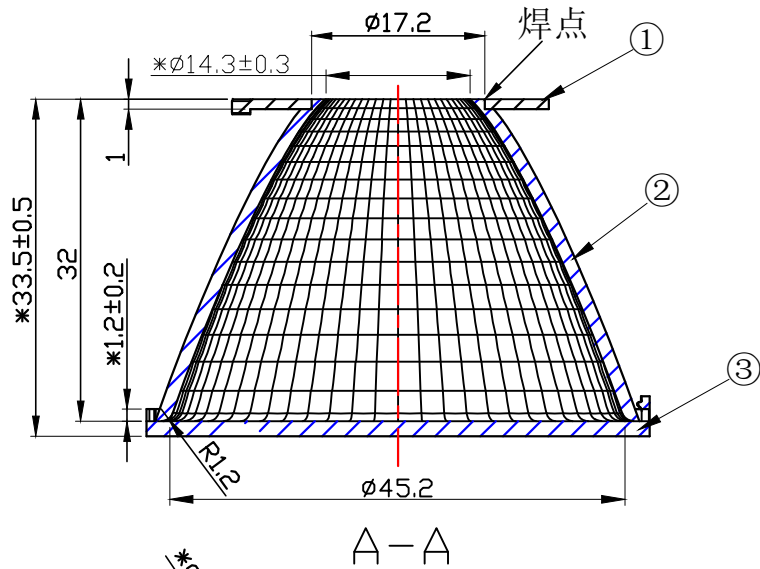

Light Source	CITIZEN CLU028
PlasticHolder	92.70.124.00
Metal Adaptor	
Design Angle	36° ± 3°
Measured Angle	
Efficiency	

光学装配示意图

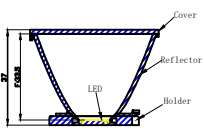

Technical requirements:

1. Material: AL.
2. Surface treatment: Andoizing.
3. Product untolerance reference untolerance table.

P/N:		91.01.1221.000		版本/REV	K1
产品名称		Product Name		1-1221-L	
客户代号		Customer Code		NT	
客户编号		Customer Item		EW-D50-36°	
标记	处数	更改内容	签名	更改日期	工程图 Engineering drawings
Mark	Issued Times	Amended Content	Signature	Amended Date	
设计	区工	制图	比例	1:1	
工艺		审核	视角		
批准		日期	页数	共1页 第1页	图档路径 The path of file
Approval		Date	2022.05.11		Nata®